

THE GEMINI BUILDING

• BUCKTOWN •



1860 NORTH MILWAUKEE AVENUE, CHICAGO, IL

CONTACT INFORMATION

BRENDAN REEDY

p: 312.470.2306

e: brendan.reedy@cushwake.com

MEREDITH OLIVER

p: 312.470.1829

e: meredith.oliver@cushwake.com





MARKET SUMMARY

- Located between the “The 606” Bloomingdale Trail and Western Ave, The Gemini Building sits in the middle of a dynamic trade area exploding with new retail and restaurant concepts as well as hundreds of brand new residential units.
- One block north of The 606 entrance - thousands of pedestrians each day.
- One block south of the Milwaukee/Western Blue Line - 1,780,000 riders per year and the City’s busiest bus stop at Western – 9,200,000 riders per year.
- Within just a few blocks are exciting shops and restaurants including Ipsento, Bow & Arrow Collection, City Soles, Zen Garage, Silom 12, Irazu and Remedy Bar.

BUILDING DETAILS

- 4,400 square foot free-standing building
- Highly desirable corner location with 18’ sidewalks spanning the depth of the building
- Complete building renovation underway including new storefront, windows, roof and mechanical systems
- Ability to brand the building with colors and signage
- Completely column-free space with 15’+ clearance throughout

DEMOGRAPHICS

	0.5 MILE	1 MILE	1.5 MILE
Average HH Income	\$124,903	\$98,786	\$99,320
Population	17,520	61,911	134,067
Households	8,561	28,681	60,043

CONTACT INFORMATION

BRENDAN REEDY

p: 312.470.2306

e: brendan.reedy@cushwake.com

MEREDITH OLIVER

p: 312.470.1829

e: meredith.oliver@cushwake.com



SITE PLAN

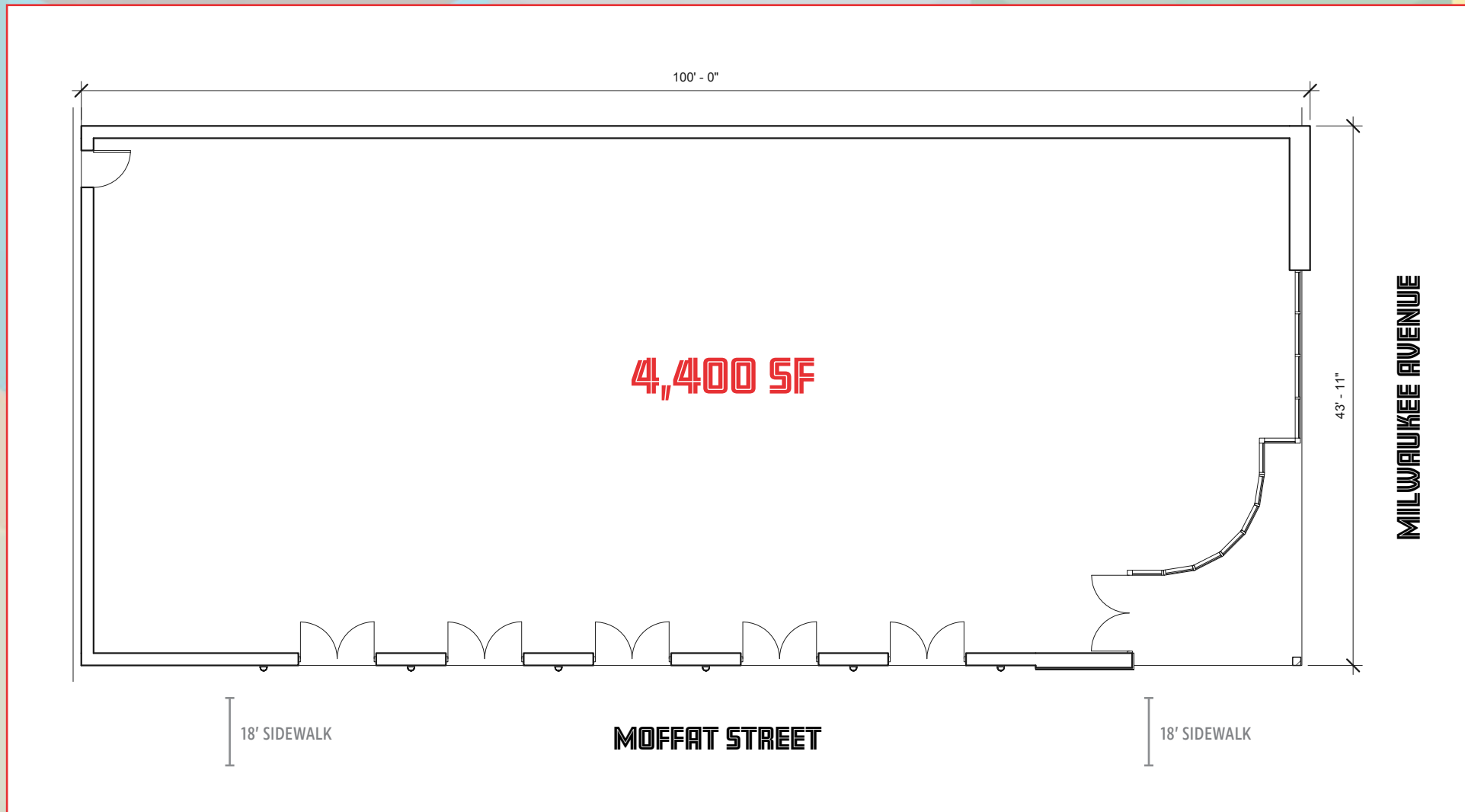

CONTACT INFORMATION

BRENDAN REEDY
p: 312.470.2306
e: brendan.reedy@cushwake.com

MEREDITH OLIVER
p: 312.470.1829
e: meredith.oliver@cushwake.com

MARKET MAP



CONTACT INFORMATION

BRENDAN REEDY
 p: 312.470.2306
 e: brendan.reedy@cushwake.com

MEREDITH OLIVER
 p: 312.470.1829
 e: meredith.oliver@cushwake.com

